

## Specifications - Cooling Only (R-22) -

Model	Indoor unit		FD75CV1M	FD100CV1M	FD125BY1M	FD150BAY1M	FD200B2Y1M	FD250B2Y1M		
	Outdoor unit		R72CV1ME	R100BAY1ME	R125BY1ME	R150CAY1ME	R100BAY1ME x2	R125BY1ME x2		
Capacity	Btu/h		70,000	100,000	125,000	150,000	200,000	250,000		
	kW		20.5	29.3	36.6	44	58.6	73.3		
Total Input Power	W		7,000	10,500	12,300	16,700	21,100	25,100		
Running Current	A		12.2	17.8	22.5	29.1	39.80	45.4		
Power Source	V/Ph/Hz		380-415 / 3 / 50							
Refrigerant Type			R22							
Indoor Unit	Control	Operation	SLM+AC5300 (Option)						Sequential	
		Air Flow	Super High	l/s / cfm	1180 / 2500	1511 / 3200	1982 / 4200	2171 / 4600	3021 / 6400	3776 / 8000
			High	l/s / cfm	992 / 2100	1393 / 2950	-	-	-	-
			Medium	l/s / cfm	897 / 1900	1275 / 2700	-	-	-	-
	Low		l/s / cfm	756 / 1600	1157 / 2450	-	-	-	-	
	External Static Pressure	Super High	Pa / in.wg	100 / 0.40	-	149 / 0.6	-	158 / 0.6	200 / 0.8	
		High	Pa / in.wg	80 / 0.32	-	-	-	-	-	
		Medium	Pa / in.wg	60 / 0.24	-	-	-	-	-	
		Low	Pa / in.wg	40 / 0.16	-	-	-	-	-	
	Sound Pressure Level	dBA		54	57	58	59	61	63	
	Unit Dimension	Height	mm / in	430 / 16.93	-	-	885 / 34.8	-	1291 / 50.8	
		Width	mm / in	1372 / 54.02	1599 / 62.96	1540 / 60.7	-	1794 / 70.7	1766 / 69.6	
		Depth	mm / in	784 / 30.87	-	1040 / 40.9	-	-	1199 / 47.2	
	Packing Dimension	Height	mm / in	642 / 25.28	-	1154 / 45.4	-	-	1506 / 59.3	
		Width	mm / in	1586 / 62.45	1815 / 71.46	1787 / 70.4	2052 / 80.8	2034 / 80.1	2034 / 80.1	
Depth		mm / in	930 / 36.62	-	1188 / 46.8	-	-	1412 / 55.6		
Unit Weight	kg/lb		92 / 202.4	119 / 261.8	176 / 388	189 / 417	220 / 486	343 / 757		
Condensate Drain Size	mm/in		25.40 / 1.00							
Outdoor Unit	Air Flow	l/s / cfm	2832 / 6000	3304 / 7000	2629 / 6200	5475 / 11600	3304 / 7000	3304 / 7000		
		dBA	73	65	73	65	73	65		
	Unit Dimension	Height	mm / in	946 / 37.24	-	1041 / 41.0	-	946 / 37.2		
		Width	mm / in	1300 / 51.18	-	1116 / 43.9	-	1116 / 43.9		
		Depth	mm / in	500 / 19.68	-	939 / 37.0	-	939 / 37.0		
	Packing Dimension	Height	mm / in	1132 / 44.6	-	1227 / 48.3	-	1132 / 44.6		
		Width	mm / in	1414 / 55.66	-	1312 / 51.7	-	1312 / 51.7		
		Depth	mm / in	664 / 26.14	-	1112 / 43.8	-	1112 / 43.8		
	Unit Weight	kg/lb		145 / 320	164 / 362	169 / 373	227 / 500	164 / 361		
	Pipe Connection	Type		BRAZING						
	Size	Liquid	mm / in	12.7 / 1/2	-	15.88 / 5/8	-	15.88 / 5/8	-	
		Gas	mm / in	25.4 / 1	28.58 / 1 1/8	34.92 / 1 3/8	28.58 / 1 1/8	34.92 / 1 3/8		
	Refrigerant Charge (At 7.5m Pipe Length)	kg / lb		5.5 / 12.10	8.10 / 17.86	8.00 / 17.60	9.90 / 21.78	7.6 (x2) / 16.8 (x2)	8.0 (x2) / 17.5 (x2)	

Model	Indoor unit		FD300B2Y1M	FD350B3Y1M	FD400B4Y1M	FD450B3Y1M	FD500B4Y1M	FD600B4Y1M		
	Outdoor unit		R150CAY1ME x2	R100BAY1ME	R125BY1ME x2	R100BAY1ME x4	R150CAY1ME x3	R125BY1ME x4	R150CAY1ME x4	
Capacity	Btu/h		300,000	350,000	400,000	450,000	500,000	600,000		
	kW		87.9	102.5	117.2	131.9	146.5	175.8		
Total Input Power	W		34,500	35,500	41,800	53,000	51,600	73,800		
Running Current	A		59.1	64.8	78.2	90.5	92.9	125.4		
Power Source	V/Ph/Hz		380-415 / 3 / 50							
Refrigerant Type			R22							
Indoor Unit	Control	Operation	Sequential							
		Air Flow	Super High	l/s / cfm	4248 / 9000	4956 / 10500	5664 / 12000	6372 / 13500	7080 / 15000	8496 / 18000
			High	l/s / cfm	-	-	-	-	-	-
			Medium	l/s / cfm	-	-	-	-	-	-
	Low		l/s / cfm	-	-	-	-	-	-	
	External Static Pressure	Super High	Pa / in.wg	-	200 / 0.8	-	250 / 1.0	-	300 / 1.2	
		High	Pa / in.wg	-	-	-	-	-	-	
		Medium	Pa / in.wg	-	-	-	-	-	-	
		Low	Pa / in.wg	-	-	-	-	-	-	
	Sound Pressure Level	dBA		66	-	68	-	70		
	Unit Dimension	Height	mm / in	1291 / 50.8	-	1546 / 60.9	-	1978 / 77.9		
		Width	mm / in	1766 / 69.6	2022 / 79.7	-	2174 / 85.6	-		
		Depth	mm / in	1199 / 47.2	-	1466 / 57.7	-	1905 / 75.0		
	Packing Dimension	Height	mm / in	1506 / 59.3	-	1766 / 69.5	-	2123 / 83.6		
		Width	mm / in	2034 / 80.1	2279 / 89.7	2431 / 95.7	1684 / 66.3	2399 / 94.4		
Depth		mm / in	1412 / 55.5	-	1684 / 66.3	-	2005 / 78.9			
Unit Weight	kg/lb		343 / 757	440 / 970	513 / 1131	564 / 1244	991 / 2185			
Condensate Drain Size	mm/in		25.4 / 1.0							
Outdoor Unit	Air Flow	l/s / cfm	5475 / 11600	3304 / 7000	5475 / 11600	3304 / 7000	5475 / 11600			
		dBA	74	65	74	65	74			
	Unit Dimension	Height	mm / in	1041 / 41.0	946 / 37.2	1116 / 43.9	1041 / 41.0	946 / 37.2		
		Width	mm / in	1300 / 51.18	1116 / 43.9	1116 / 43.9	946 / 37.2	1041 / 41.0		
		Depth	mm / in	500 / 19.68	939 / 37.0	939 / 37.0	939 / 37.0	939 / 37.0		
	Packing Dimension	Height	mm / in	1227 / 48.3	1132 / 44.6	1227 / 48.3	1132 / 44.6	1227 / 48.3		
		Width	mm / in	1414 / 55.66	1312 / 51.7	1312 / 51.7	1312 / 51.7	1312 / 51.7		
		Depth	mm / in	664 / 26.14	1112 / 43.8	1112 / 43.8	1112 / 43.8	1112 / 43.8		
	Unit Weight	kg/lb		227 / 500	164 / 361	169 / 372	164 / 361	227 / 500		
	Pipe Connection	Type		BRAZING						
	Size	Liquid	mm / in	12.7 / 1/2	-	15.88 / 5/8	-	15.88 / 5/8	-	
		Gas	mm / in	25.4 / 1	28.58 / 1 1/8	34.92 / 1 3/8	28.58 / 1 1/8	34.92 / 1 3/8		
	Refrigerant Charge (At 7.5m Pipe Length)	kg / lb		10.1 (x2) / 22.3 (x2)	7.6 / 16.8	8.0 (x2) / 17.5 (x2)	7.6 (x4) / 16.8 (x4)	10.1 (x3) / 22.3 (x3)	8.0 (x4) / 17.5 (x4)	

- Note:
- All specifications are subjected to change by the manufacturer without prior notice.
  - All units are being tested and comply to ARI 210/240-04
  - Cooling capacity is based on the conditions below:  
Cooling - 26.7°C DB / 19.4°C WB indoor and 35°C DB / 23.9°C WB outdoor
  - Refrigerant (R-22) is not pre-charged at factory shipment

**SLM Controller + AC5300 Controller**  
(Standard) (Option)

Applies to: FD75C / 100C / 125B / 150B

**Features**

- Temperature setting
- Operation modes (Cool/Dry/Fan)
- Fan speed selection
- Timer
- Sleep mode
- Sensor
- LED display

**Sequential controller**

Applies to: FD200 / 250 / 300 / 350 / 400 / 450 / 500 / 600B

This controller is supplied as the standard specification for cooling model where the systems are matching with two outdoor units and more. The benefit of this controller is capable of part-loading of the system capacity.

This controller has a LED indicator, a LCD display panel, 5VDC power supply input, and two communication input/output port.

**Features**

- Cool/Fan/Dry modes
- Single fan speed (High speed)
- Set temperature in C° or °F
- Save function
- Test run function
- 7 days programmable timer (option)
- Compressors Run/Error status
- Error indicator
- Key lock function
- Last state memory (battery backup or backup setting from main board)

- Warning**
- Ask a qualified installer or contractor to install this product. Do not try to install the product yourself. Improper installation can result in water or refrigerant leakage, electrical shock, fire or explosion.
  - Use only those parts and accessories supplied or specified by Daikin. Ask a qualified installer or contractor to install those parts and accessories. Use of unauthorised parts and accessories or improper installation of parts and accessories can result in water or refrigerant leakage, electrical shock, fire or explosion.
  - Read the User's Manual carefully before using this product. The User's Manual provides important safety instructions and warnings. Be sure to follow these instructions and warnings.

- Cautions on product corrosion**
- Air conditioners should not be installed in areas where corrosive gases, such as acid gas or alkaline gas, are produced.
  - If the unit is to be installed close to the sea shore, direct exposure to the sea breeze should be avoided. If you need to install the unit close to the sea shore, contact your local distributor.

**MARKETING HEAD QUARTERS**  
**DAIKIN AIRCONDITIONING INDIA PVT. LTD.**  
 12<sup>th</sup> Floor, Building No. 9, Tower A, DLF Cyber City, DLF Phase III, Gurgaon-122002, Haryana, India.  
 Tel.: 0124-4555444, Fax.: 0124-4555333 email: ho@daikinindia.com

**SALES & SERVICE OFFICES**

Ahmedabad - Tel.: 079-26583013-14, 32988495	Delhi - NCR - Tel.: 0124-4555444	Lucknow - Tel.: 0522-2787307/340/291
Bengaluru - Tel.: 080-25590452-54	Hyderabad - Tel.: 040-32971231	Mumbai - Tel.: 022-30926666
Chandigarh - Tel.: 0172-5089862/63/64	Jaipur - Tel.: 0141-2223215/439	Pune - Tel.: 020-25560300-3
Chennai - Tel.: 044-24314210-15	Kolkata - Tel.: 033-22894259/60	

• Specifications, designs and other content appearing in this brochure are current as of January 2010 but subject to change without notice.

DAIPL-13C

# High Static Pressure Duct Type

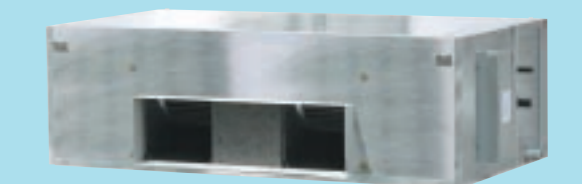

FD75/100CV1M



FD125BY1M/FD150BAY1M

**Cooling Only [50Hz]**

**R-22**

# Unit can be mounted in the ceiling and air can be delivered freely by duct.

## Cooling Only

	75	100	125	150	200	250
Btu/h	70,000	100,000	125,000	150,000	200,000	250,000
kW	20.5	29.3	36.6	44.0	58.6	73.3
Indoor unit						
	FD75CV1M	FD100CV1M	FD125BY1M	FD150BAY1M	FD200B2Y1M	FD250B2Y1M
Outdoor unit						
	R72CY1ME	R100BAY1ME	R125BY1ME	R150CAY1ME	R100BAY1ME x 2	R125BY1ME x 2

	300	350	400	450	500	600
Btu/h	300,000	350,000	400,000	450,500	500,000	600,000
kW	87.9	102.6	117.2	131.9	146.5	175.8
Indoor unit						
	FD300B2Y1M	FD350B3Y1M	FD400B4Y1M	FD450B3Y1M	FD500B4Y1M	FD600B4Y1M
Outdoor unit						
	R150CAY1ME x 2	R100BAY1ME R125BY1ME x 2	R100BAY1ME x 4	R150CAY1ME x 3	R125BY1ME x 4	R150CAY1ME x 4

## Comfortable

- **Superior air distribution for comfortable living**  
The conditioned air can be effectively distributed to every corner of the room through the ducting and this realise a more pleasant environment for comfort living.

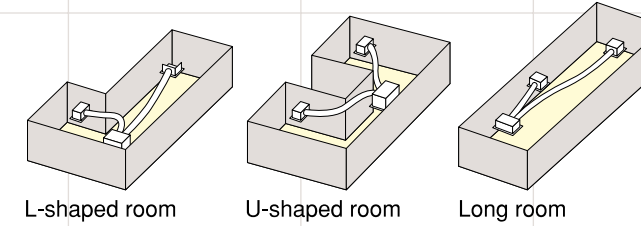

- **Air discharge orientation**  
FD75-200 models come with standard horizontal air discharge. FD250-500 models only come with standard vertical air discharge and they can be converted to horizontal air discharge at the site. FD250-500B models with horizontal air discharge are not offered from factory. FD600B models are offered in vertical and horizontal air discharge as standard by differentiate of nomenclature.

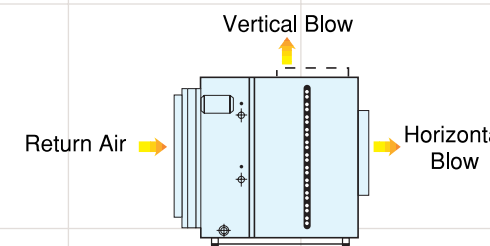

- **Flexibility of air supply**  
FD125-600 models using belt driven blower such as that the air volume and static required can be adjusted according to the requirement. This flexibility allows for wider application.
- **Versatility**  
Multiple rooms can be cooled together at the same time by using just one unit of fan coil unit.
- **Fresh air intake for healthy living**  
Fresh air can be introduced into the building through the design of fresh air intakes. This will help to improve the indoor air quality.



## Compact

- **Compact design of built-in type helps blend with interior decor.**  
Indoor models are designed with compact size with twin coil structure. This design is able to provide some saving in space for installation.
- **Low Height**  
Both FD75 and FD100 offer lower height at 430mm only. With this, the unit allows more ceiling height space for interior design.

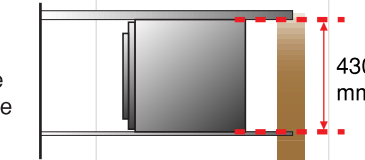

## Work & Servicing

- **Easy maintenance**  
The simple design concept has provided the ease of maintenance and servicing. Access to the internal part of the unit can be from the service panel or other side of the unit by loosening a few screws.

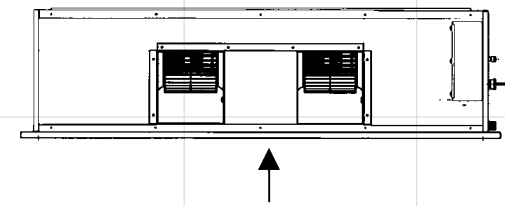

- **Air filter as standard**  
Washable Air Filter is equipped as standard.

## Outdoor Unit

- **Scroll compressor**  
All outdoor units are using scroll compressor which has better energy efficiency and quiet in operation.
- **Anti-corrosion of heat exchanger fin**  
The heat exchanger fin of outdoor units are anti-corrosion treated. (Gold Fin)

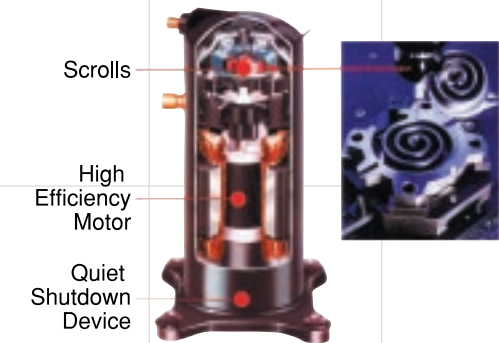

## Remote controller



SLM Controller (Standard)

AC5300 Controller (Option)

Sequential Controller (Standard)

• Please refer to backcover.

1) Cooling and Heating capacity of 75/100 models are based on: Cooling-27°C DB / 19°C WB indoor and 35°C DB / 24°C WB outdoor.  
Cooling and Heating capacity of 125-600 models are based on: Cooling-26.7°C DB / 19.4°C WB indoor and 35°C DB / 23.9°C WB outdoor.  
2) Please see the specification table for exact measurements of the indoor and outdoor units.